

SUPERVISOR & SUBCONTRACTORS TO CHECK ALL SET OUT DIMENSIONS AGAINST FINAL APPROVED PLANS PRIOR TO COMMENCEMENT OF CONSTRUCTION.
ANY DISCREPANCIES REVEALED IN SET OUT DIMENSIONS TO BE REPORTED IMMEDIATELY TO SURVEYORS PRIOR TO WORK PROCEEDING.

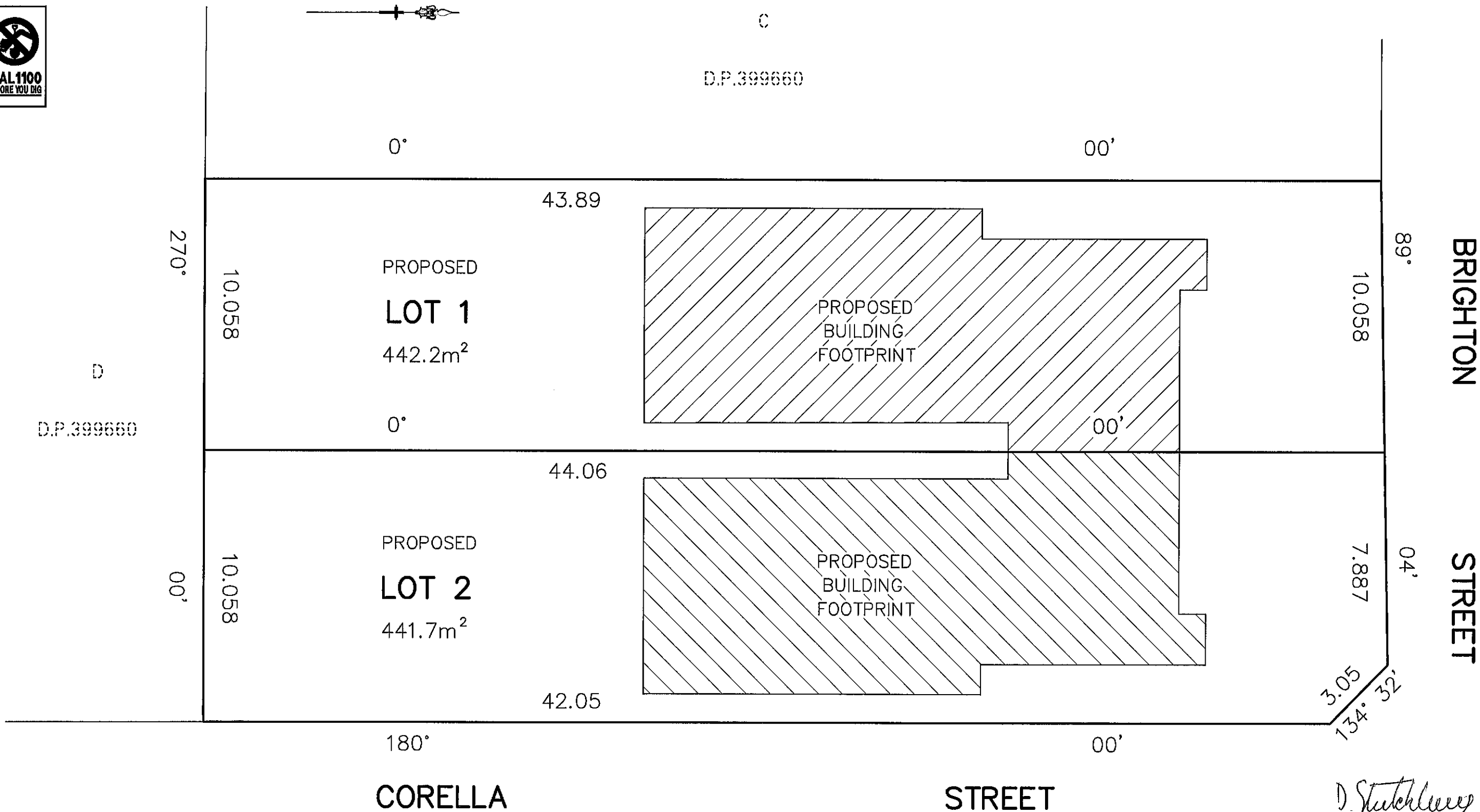

DIAL 1100
BEFORE YOU DIG



- THE PROPOSED PLAN OF SUBDIVISION HAS BEEN PREPARED FOR DEVELOPMENT APPLICATION PURPOSES ONLY.
- DIMENSIONS AND AREAS SHOWN ON THIS PLAN HAVE BEEN COMPILED FROM D.P.359775 AND ARE SUBJECT TO FINAL SURVEY.
- THE LOCATION AND EXTENT OF PROPOSED EASEMENTS IS SUBJECT TO APPROVAL OF THE DEVELOPMENT APPLICATION AND SUBSEQUENT CONDITIONS OF CONSENT.



PROPOSED SUBDIVISION OF LOT A IN D.P.359775
No.6 BRIGHTON STREET, FRESHWATER.
FOR GREG MAILMAN

LEVELS SHOWN ARE TO N/A DATUM. CLIENT REF. No. N/A

D. Stutchbury
REGISTERED SURVEYOR
STUTCHBURY JAKUES P/L
Land Surveying Consultants

P.O.Box 7249
BROOKVALE NSW 2100

TEL: (02) 8976 1600
FAX: (02) 8976 1655

DATE: 23/11/2020

REF:11008/20